

# MAB 485 Swivel Base

The best introduction to the ProfiPLUS category - with the swivel base adjusting feature.

**Tangible relief for operators when performing drilling works overhead or in horizontal situations.** A good idea comes to life: BDS now offers four machines with a moveable magnetic adjustment feature in two performance categories.

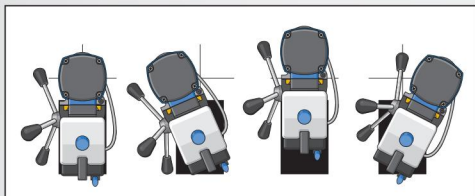

A larger swivel range



Release the adjustment feature

How the swivel base works: place the machine roughly in position, activate the magnet, release the adjustment feature and adjust it effortlessly. The swivel base enables the drill to be placed in exactly the right position without needing to hold the whole weight of the machine at the same time. This relief is an additional factor in work safety even when the machine is secured with a chain.



## The advantages of the MAB 485 Swivel Base

- > Continuous electronic control of motor output and speed
- > Drilling with core and twist drills, countersinking, reaming, thread cutting
- > Two-stage gear unit, non-destructive with oil bath gearbox
- > With Swivel Base, the adjustment feature for an easy positioning of the drill



### SPECIFICATION

	Motor output:	1150 Watt
	Voltage:	230 V AC, 50-60 Hz
	Stroke:	160 mm
	Swivel Base, adjustment feature:	✓
	Magnet size:	84 x 168 x 41.5 mm
	Weight:	13 kg
	Direct arbor:	-
	Industrial arbor:	-
	Quick change drill chuck system:	KEYLESS, 19 mm Weldon ( $\frac{3}{4}$ "
	Morse taper:	MT 2
	Speed range 1:	50 – 250 min <sup>-1</sup>
	Speed range 2:	180 – 450 min <sup>-1</sup>
	Speed range 3:	-
	Speed range 4:	-
	Permanent internal lubrication:	✓

	Friction clutch:	-
	Torque control:	-
	Full wave control electronics:	✓
	Magnet indicator:	✓
	Overheating protection:	✓
	CW/CCW rotation:	✓
	Carbon brush wear control:	✓
	Core drill short 30 mm:	12 – 40 mm
	Core drill long 55 mm:	12 – 40 mm
	Core drill overlong 75 mm:	-
	Core drill extra-long 110 mm:	-
	Twist drilling:	≤ ø 18 mm
	Reaming:	≤ ø 18 mm
	Countersinking:	≤ ø 40 mm
	Thread cutting:	≤ M16

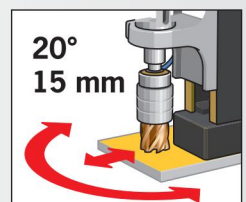

Swivel Base adjustment feature

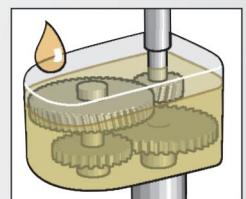

Two-stage oil bath gearbox

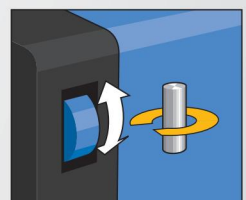

Full wave control electronics

### ORDER NO.

MAB 485 SB 230 Volt  
MAB 485 SB 110/125 Volt

Technical drawing: Page 42-43  
Thread cutting systems: Page 70-71

### SCOPE OF DELIVERY

1 Magnetic core drilling machine	1 Hard protective case
1 Quick change drill chuck system KEYLESS, 19 mm Weldon ( $\frac{3}{4}$ "	1 Safety chain
1 Tapping adapter ZGA 010 + ZGA 012 + ZGA 016	1 Drill drift MT 2
1 Ejector pin ZAK 075 + 100	1 Gear rim drill chuck 1 – 13 mm
	1 Taper drift MT 2/B16
	1 Operating manual